

卓越性能 来自不断的淬炼
Excellent performance comes from
constant refinement

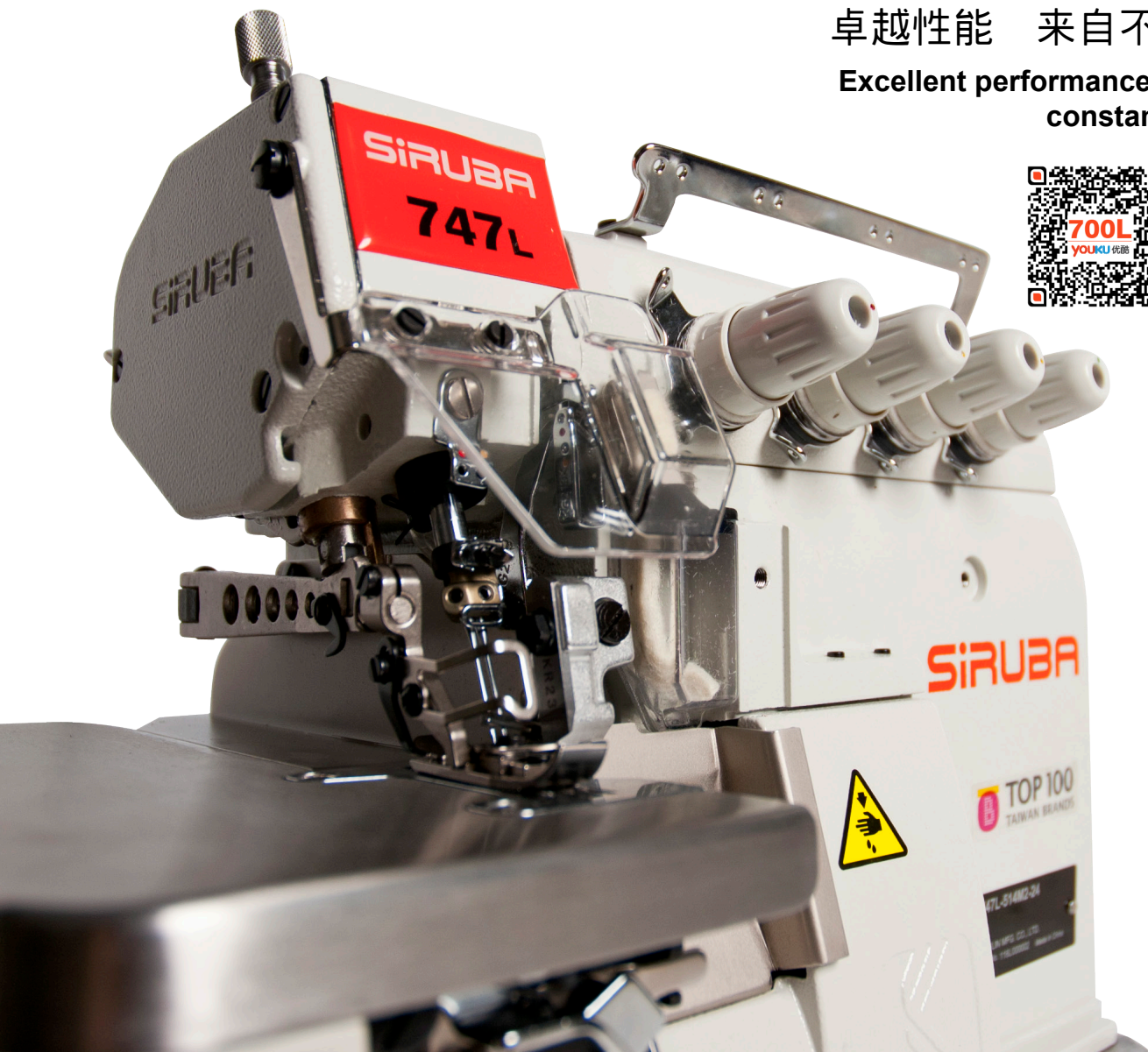

700L SERIES

700L

超高速包缝 / 安全缝纫机
Ultra High Speed Overlock/ Safety Stitch Machine

700LX

微油型超高速包缝 / 安全缝纫机
Semi-Dry Ultra High Speed Overlock/
Safety Stitch Machine

700LD

直驱超高速包缝 / 安全缝纫机
Direct-drive Ultra High
Speed Overlock/ Safety
Stitch Machine



700LX

700L SERIES

Ultra High Speed Overlock/ Safety Stitch machine

747 L - 514 M - 2 - 2 4 / VT

线数 Thread numbers
737 : 3T
747 : 4T
757 : 5T
767 : 6T

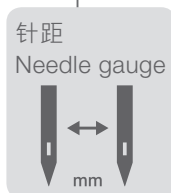

配件
Device

机种别 Model	
L	基本型 Basic Type
LX	微油型 Semi-Dry Type
LD	直驱马达型 Direct-Drive Servo Motor Type

缝合方式 Sewing types	
503	
504	
505	
512	
514	
516	
644 (514+401)	

车缝布料/ 上勾针缝容量 Sewing Fabric / Upper Looper capacity	
F	轻薄布料 Fine weight fabric
L	薄布料 Light weight fabric
M	中厚布料 Medium weight fabric
H	厚布料 Heavy weight fabric
X	特厚布料 Extra heavy weight fabric

10X10

7X7

6X6

5X5

4X4

X H M L F

送具型式 Feed dog type	
1	1排 (标准) 1 row (standard)
2	2排 (标准) 2 row (standard)
3	3排 (标准) 3 row (standard)
4	4排 (标准) 4 row (standard)
5	5排 (标准) 5 row (standard)
6	1排 (特殊) 1 row (special)
7	2排 (特殊) 2 row (special)
8	3排 (特殊) 3 row (special)
9	4排 (特殊) 4 row (special)
0	5排 (特殊) 5 row (special)

700LD SERIES

700L Overlock Sewing Machine with Direct-Drive Servo Motor

747LD-514M-3-24/ ECA / DKLH1-1

配件
Device

DKLH1-□

直驱电控组
Direct-drive Control Set

0	经济型 Economic Type
1	多功能气动型 Multi-function Pneumatic Type
2	多功能电动型 Multi-function Electric Type



700L series

在 Siruba 包缝机技术的既有基础上，大幅度提升性能

Based on Siruba overlock technology, we greatly enhance the performance.

在控线与送布的根本性能的追求，实现了完美的缝纫质量

过线系统全面优化，在每一个细节都考虑了线的张力状态，实现了极佳的控线能力。送具、压具与切布刀的综合调校，使得送布性能达到优化。在面料的厚薄适用性，700L在规格上有更全面的对应，实现了令人满意的车缝质量。

在机械精度的追求，达到高速运转下的稳定性

提升零件的制造工艺，在精度、表面处理、内孔精加工和零件的轻量化设计，每一个细节都有严谨的配合，实现了高速、稳定、低噪音与低振动的机械性能。

车缝应用的范围更宽

针对车缝面料的厚度，在规格上(包括规格组、上勾针行程、机构时位...等)有更全面的对应，在超薄或超厚的车缝情形，都有令人满意的车缝质量

In pursuit of the core performance of thread controlling and fabric feeding, it realizes perfect sewing quality.

Threading system is fully optimized. As we fine-tuned every detail about the thread tension, it realizes a very good thread controlling. The feed dog, presser foot, and fabric trimmer are well coherent to make the fabric feeding optimized. Regarding the applicability range of fabric weight, 700L has a more comprehensive correspondence by specification, and realizes the satisfactory seam quality.

In pursuit of mechanical precision, it realizes the stability under high speed operation.

Improving the spare parts manufacturing process, the spare parts manufacturing process is improved. As the precision, surface treatment, micro-finish honing and parts light weight design are strictly coordinated in details, it realizes the high speed, stable, low noise and vibration mechanical performance.

The bigger range of sewing application

Regarding sewing material thickness, we have a full specification (including gauge set, upper looper stroke, mechanical timing...etc) to satisfy customer requirement. We provide the nice seam quality in sewing fine or extra heavy material.

700LX series

SIRUBA 的乾式润滑技术提供更乾净的缝制体验

Upgrade sewing experience with SIRUBA's state-of-the-art oil-free technology.

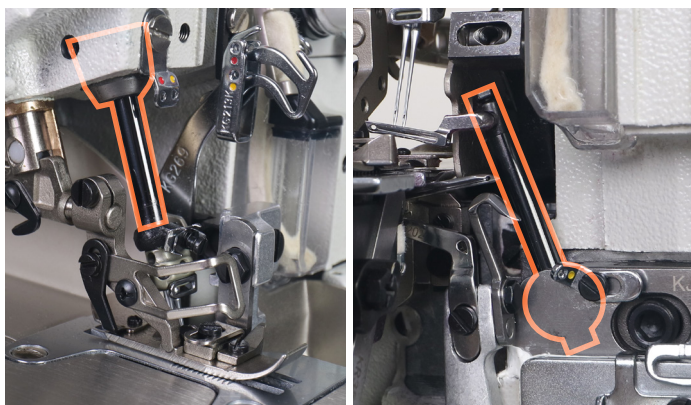

针棒与上勾针机构采特殊表面处理，缝制时无油污、无油渍飞溅。在大幅提升缝制品质的同时，减少重工与缝制品脏污的困扰。

Needle bar and upper looper mechanism re-designed with new surface treatment, no oil stains and oil splash during sewing, greatly increase quality and reduce rework to achieve higher efficiency.

所有700L与700LD的规格皆可对应,例如:

All 700L and 700LD's specifications are available. For example:

- 737L-503M-3-04 → 737LX-503M-3-04
- 747LD-514M-3-24/ECA → 747LX-514M-3-24/ECA

700L/700LX		布料厚度 Fabric Weight											
		L	M	H									
一般包缝 General Seaming	737L-503M-3-04				1	2	-	4	0.7-2	3.6	6	#11	7500
	737L-504F-2-04				1	3	-	4	0.7-2	3.6	5	#11	7500
	737L-504M-3-0□				1	3	-	4,5	0.7-2	3.6	6	#11	7500
	747L-512M-3-25				2	4	2	5	0.7-2	3.6	5.5	#11	7500
	747L-512M-3-34				2	4	3	4	0.7-2	3.6	5.5	#11	7500
	747L-514M-3-2□				2	4	2	3,4,5	0.7-2	3.6	5.5	#11	7500
	747L-514H-3-28				2	4	2	8	0.7-2	3.6	4	#11	6500
	757L-516L-2-24				2	5	2	4	0.7-2	3.6	5.5	#14	7500
	757L-516L-2-35				2	5	3	5	0.7-2	3.6	5.5	#14	7500
	757L-516M-3-35				2	5	3	5	0.7-2	3.6	5.5	#14	7500
	757L-516M-3-55				2	5	5	5	0.7-2	3.6	5.5	#14	7500
	767L-644M-3-324				3	6	3+2	4	0.7-2	3.6	5	#11	7000
	767L-644M-3-524				3	6	5+2	4	0.7-2	3.6	5	#11	7000
超薄布防起皱 Fine Fabric with Anti Puckering	747L-514F-3-23				2	4	2	3	0.7-2	3.6	5	#11	7500
	747L-514F-3-24				2	4	2	4	0.7-2	3.6	5	#11	7500
	757L-516F-2-34				2	5	3	4	0.7-2	3.6	5	#11	7500
细包缝 Fine Edging	737L-504F-2-02/GAL				1	3	-	2	0.7-2	3.6	5	#9	7500
	737L-504F-2-15				1	3	-	1.5	0.7-2	3.6	5	#9	7500
	737L-504M-2-15				1	3	-	1.5	0.7-2	3.6	6	#9	7500
肩带包缝 Tape Inserting	747L-514M-3-24/TG				2	4	2	4	0.7-2	3.6	5.5	#11	7500
	747L-514M-3-25/TG				2	4	2	5	0.7-2	3.6	5.5	#11	7500
拷下摆 Blind Hemming	737L-505F-2-04				1	3	-	4	0.7-2	3.6	5	#9	7500
松紧带车缝 Elastic Attaching	737L-504M-3-04/LFC-3				1	3	-	4	0.7-2	3.6	6	#11	6500
	747L-514M-3-2□/LFC-3				2	4	2	4,5	0.7-2	3.6	5.5	#11	6500
	747L-514M-3-2□/SMK				2	4	2	4,5	0.7-2	3.6	5.5	#11	7500
	737L-504M-3-04/TR				1	3	-	4	0.7-2	3.6	6	#11	7500
摺景车缝 Gathering	747L-514M-8-24/GA				2	4	2	4	0.7-2	3.6	5.5	#11	7000
	757L-516M-8-35/GA				2	5	3	5	0.7-2	3.6	5.5	#14	7000
	757L-516M-8-55/GA				2	5	5	5	0.7-2	3.6	5.5	#14	7000
手动线头包缝 Manual Back Latching Seaming	737L-504M-7-04/BK(BK-1)				1	3	-	4	0.7-2	3.6	6	#11	7500
	747L-514M-7-2□/BK(BK-1)				2	4	2	3,4,5	0.7-2	3.6	5.5	#11	7500
	747L-514H-7-2□/BK(BK-1)				2	4	2	4,5	0.7-2	3.6	7	#16	7500
全自动手动线头包缝 Fully Auto Back Latching Seaming	737L-504M-5-04/BKF				1	4	2	4	0.7-2	3.6	6	#11	7500
	747L-514M-5-23/BKF				2	4	2	4	0.7-2	3.6	5.5	#11	7500
厚毛衣料包缝 Over Seaming On Bulky Knitwear	747L-514H-4-24				2	4	2	4	0.7-2	3.6	7	#16	6500
	747L-514H-4-25				2	4	2	5	0.7-2	3.6	7	#16	6500
牛仔安全缝 Jeans Safety Stitch	757L-516H-3-5□				2	5	5	5,6	0.7-2	3.6	7	#16	6000
	757L-516X-3-5□				2	5	5	5,6	0.7-2	3.6	7	#16	6000
厚毛衣料肩带包缝 Tape Inserting On Bulky Knitwear	747L-514H-4-24/TG				2	4	2	4	0.7-2	3.6	7	#16	6500
	747L-514H-4-25/TG				2	4	2	5	0.7-2	3.6	7	#16	6500

700L/700LX		布料厚度 Fabric Weight			✂	👔	↔	🧵	🔥	📏	mm	! DCX27	🔄 S.P.M. (Max)
		L	M	H									
口袋包缝 Pocket Binding	757L-516M-3-35/PS	—	—	—	2	5	3	5	0.7-2	3.6	5	#14	7000
	757L-516M-3-55/PS	—	—	—	2	5	5	5	0.7-2	3.6	5	#14	7000
	757L-401M-8-□0/TA	—	—	—	2	4	3,5	-	0.7-2	3.6	5	#14	7000
	767L-644M-3-324/PS	—	—	—	2	6	3+2	4	0.7-2	3.6	5	#14	7000
	767L-644M-3-524/PS	—	—	—	2	6	5+2	4	0.7-2	3.6	5	#14	7000
管状布条车缝 Spaghetti Sewing	737L-WR/LFC-3	—	—	—	1	3	-	-	0.7-2	3.6	-	#11	6000
拉链包缝 Zip Seaming	737L-504M-3-05/PZ	—	—	—	1	3	-	5	0.7-2	3.6	6	#14	7500
毛巾布边车缝 Towel Edging	757L-401M-6/TW	—	—	—	1	2	-	-	0.7-2	3.6	5	#14	7500

详细配件资讯请参考Siruba综合目录

Please refer to Siruba General Catalogue for the device's information.



700LX/DK1H1 700LD/DK1H1

承续 700QD 系列的丰富实战经验，Siruba 电控技术再提升

Based on the rich experience of 700QD Series, Siruba upgrades the control technology.

采用高速伺服马达

- 以充沛的动力，实现7500 RPM的运转速度
- 制造精度高，噪音小，发热低

The high speed servo motor

- By the plenty power, it realizes the operation speed of 7500 RPM.
- High precision makes low noise level and low heat.

控制器模块化设计，以多种组合，全方位满足各种需求

- 经济型：节能省电，并可驱动EC切布条装置
- 多功能型：标配电眼，侦测布料边缘，以进行自动模式车缝，并可切换半自动或手动模式
- 多功能型分为气动型与电动型，依客户的厂房设备，选择适合的规格

The controller modularized design, with a variety of combinations, comprehensively meets the various demands.

- Economic type: Energy saving, and also drives EC device, electrical tape cutter
- Multi-function type: the sensor checks fabric edge for automatic sewing mode. Also semi-auto or manual mode can be switched on demand.
- Multi-function type includes pneumatic and electrical type. Customers may choose the suitable specification according to the factory facility.

采用新型电眼，更灵敏，更精准，侦测无死角

- 体积小，安装于车布板下方，单一方向侦测布边
- 不需调整电眼位置，适用于各种车缝作业情形
- 克服因棉絮阻挡而造成感测失灵的问题

The new sensor is more sensitive, more accurate, no blind spot.

- It is very small, installed under the sewing bed, detecting the fabric by single direction.
- No need to adjust the position, apply to a variety of sewing operations.
- Overcoming the problem of sensory failure due to dust blocking.

700LD/700LX

产品组合：配件与直驱电控组

Product Package: Devices and Direct-Drive Control Sets

直驱电控组 Direct-drive Control Set	配件 Device	功能 Function	配件表 Accessory List												
			电眼 Sensor	安全 开关 Safety Switch	操作 面板 Control Panel	手动 开关 Manual Cut Switch	松线 Thread Release	切布条 Tape Cutter	吸风切线 Suction Trimmer		LED 照明 LED Light	立式 踏板 Standing Operation Padel	抬压脚 Auto Foot Lifter	吸风组 Suction Set	
									侧切 Side Cutter	平切 Flat Cutter					
DKLH1-0 经济型 (输出X 3) Economic Type (Output x 3)		一般车缝 General Sewing									●				
	VT	吸风切线 Suction Thread Trimmer								●		●		#5	#4 #5
	CT	吸风切线 Suction Thread Trimmer									●	●		#5	#4 #5
	AC	气动切布条 Pneumatic Type Tape Cutter				●			●			●			
DKLH1-1 多功能 气动型 (输出x 5) Multi-function Pneumatic Type (Output x 5)	ECA	气动切布条 Air Type Tape Cutter	●	●	●	●			●			●	#2	●	●
	VTE	吸风切线 Suction Thread Trimmer	●	●	●			#1		●		●	#2	●	●
	VTA	吸风切线 Suction Thread Trimmer	●	●	●			#1		●		●	#2	●	●
	CTE	吸风切线 Suction Thread Trimmer	●	●	●			#1			●	●	#2	●	●
	UC	上下层防卷边 Top and Bottom Anti-Curly Edge		●	●					●		●	#2	●	●
	SD	圆领衫颈后贴条 T-Shirt Neck-back Tape Attaching		●	●					●		●	#2	●	●
	BKT	简易型自动包线头 Simplified Auto Back Latch	●	●	●	●	●	●				●	#2	●	●
DKLH1-2 多功能 电动型 (输出x 5) Multi-function Electric Type (Output x 5)	ECB	电动切布条 Electric Type Tape Cutter	●	●	●	●			● Solenoid Type			●	#2	● Solenoid Type	#3
	VTE	吸风切线 Suction Thread Trimmer	●	●	●			#1		●		●	#2	● Solenoid Type	●
	CTE	吸风切线 Suction Thread Trimmer	●	●	●			#1		●		●	#2	● Solenoid Type	●

备注:

● 标准配备 / # 选配

#1: BK321-4

#2: EC467-A

#3: 1. ECB-A 气电混合型(可控制吸风时间)

2. TUD-2 纯电型(无电刷吸风马达+前后吸风组)

#4: 1. TUA-31 需有空压设备

2. TUD-2 无电刷马达驱动

#5: TUA-32K 需有空压设备

Remark:

● Standard accessory / # Optional accessory

#1: BK321-4

#2: EC467-A

#3: 1. ECB-A Air-mixed type (suction timing control)

2. TUD-2 Pure Electric type(Suction motor + from &rear suction set)

#4: 1. TUA-31 Air compressor is required.

2. TUD-2 Driven by Brushless motor

#5: TUA-32K Air compressor is required.

TUA-3X

三合一吸风集尘组

3-IN-1 SUCTION DEVICE

代号 Code	功能组件 Functional Section			搭配 配件 Collocated Device	适用机型 Applicable Model
	三吸组 3-In-1 Suction Set	气动抬压脚 Pneumatic Presser Foot Lifer	机械阀 Mechanical Type Air Switch		
TUA-31	V	V	单联 Single way	VT CT	700L / 700LX 700LD / DKLH1-0
TUA-32K			双联 Double ways		

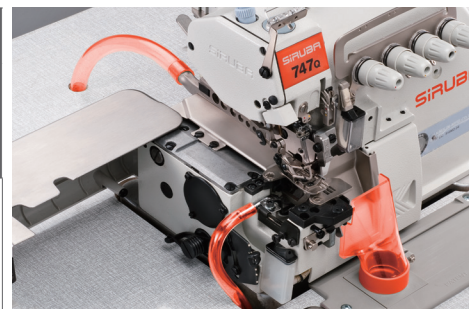

备注: 吸风组为 700LD 电眼型之标准配备

Remark: The suction set is standard accessory of 700LD sensor type models.

700LD

电眼控制型配件
Sensor-Controlled Type Device

ECA
ECB

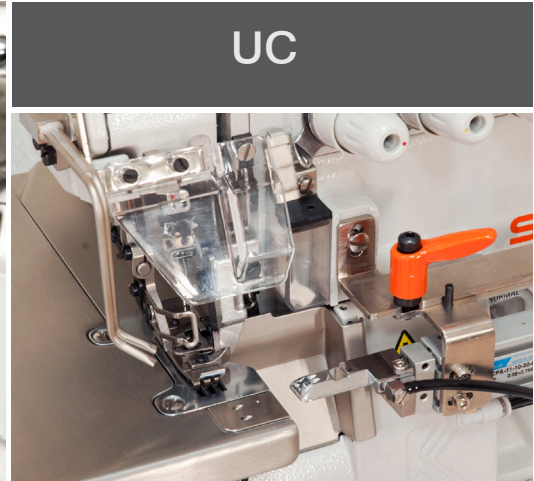
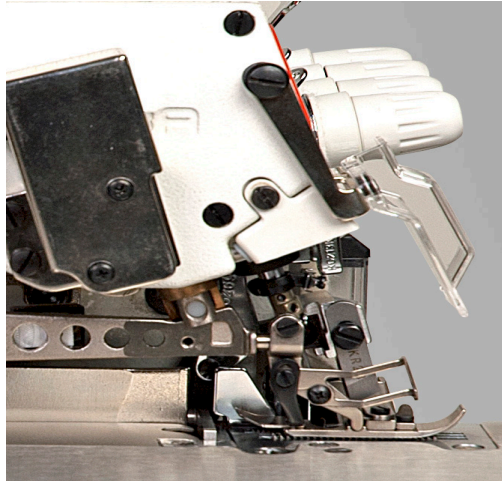

UC

CTE
VTA
VTE

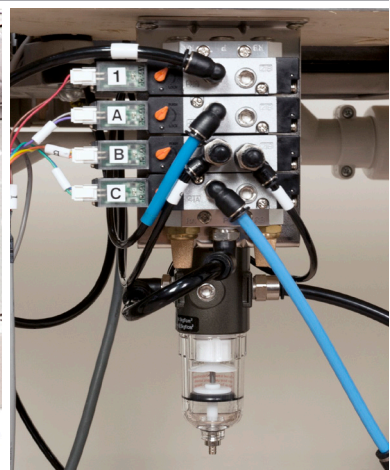
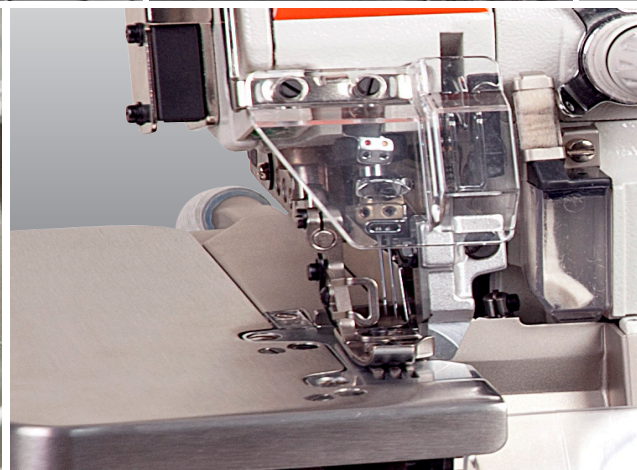
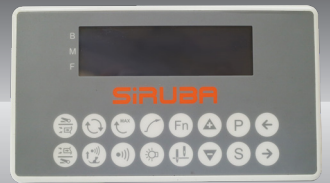
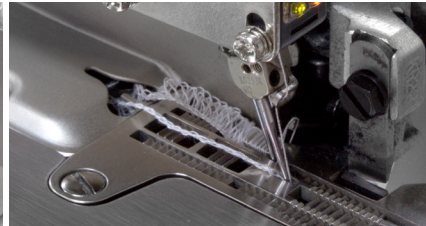
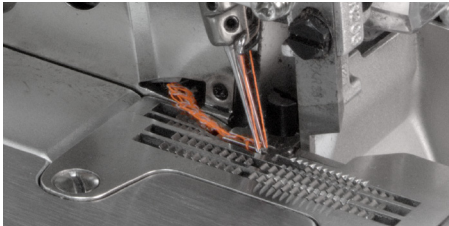

BKT

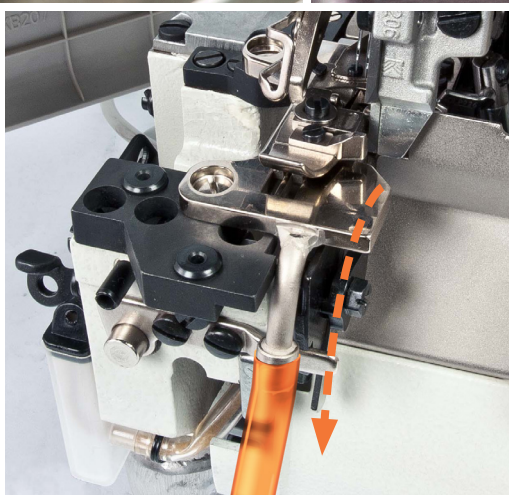

ECA**气动式切刀**
PNEUMATIC TYPE TAPE/THREAD CUTTER

采用新一代的电眼，性能再升级 ECA为气动式，ECB为电动式，搭配吸风线槽，操作更顺畅

1.手动、半自动及全自动操作模式,附转换按键，且可透过操作面板调整

2.防误切保护装置：切刀旁安装一电眼，如有被遮挡的状况下，切刀不会动作，能有效地防止切刀误切到布料

3.手动切线补偿按键，如因操作问题没有切断线，可透由此按键进行手动切线

4.手动模式下，可後踩踏板切线

5.针对网纱、强反光丝光棉等特殊面料，采用专业的电控程式控制，均能轻松车缝及完成切线，不会造成切刀误切

Brand new sensor upgrades the performance. ECA is pneumatic type, and ECB is electric type, compatible with air suction slot, which makes the operation more smoothly.

1. Manual, semi-auto and fully-auto operation mode, attached the switch keys, and could be adjusted by the panel.

2. Mistake-proof protection device: One sensor equipped near the trimmer. If the sensor is blocked, the trimmer is deactivated effectively for avoiding from cutting the fabric.

3. Manual trimming compensation stitch key: If the thread is not cut due to the operation, it can be done by the key.

4. Under the manual mode, it could be fully backward pedaled to cut the thread.

5. For those special fabrics such as mesh fabric, mercerized cotton etc, the stitches are easily accomplished as well as the trimming by the professional computer controlled without mistake-trimming.

ECB**电动式切刀**
SOLENOID TYPE TAPE/ THREAD CUTTER**ECB-A****ECB+ 气动吸风组**
ECB+PNEUMATIC SUCTION SET**CTE****水平式**
FLAT TYPE**VTA****VTE****垂直式**
SIDE TYPE**吸风切线 (附电眼节能装置)****SUCTION CHAIN-CUTTER (WITH SENSOR-CONTROLLED ENERGY-SAVING DEVICE)**

以电眼侦测布边，控制吸风功能在切线时运作，减少空压设备的能源消耗，并避免缝线浪费

1. 垂直式吸风切线适合内裤厂等轻薄及不规则的针织面料车缝，提升效率

2. 切刀之吸风口的的设计使得切线更加快速

3. 针对网纱、强反光丝光棉等特殊面料，采用专业的电控程式控制，均能轻松车缝及完成切线，不会造成切刀误切

4. 「切线後自动停车功能」以及「无面料即不车缝功能」可减少缝线的浪费

5. VTA以气缸推动切刀，减少刀刃磨损，大幅延长使用寿命

Electric eye (sensor) checks the fabric edge. It saves the energy consuming of air compressor system and also saves thread consuming.

1. Vertical suction trimming is suitable for sewing the light fabric like under-wear or irregular knitwear, to improve the efficiency.

2. The design of the suction inlet of the trimmer makes the trimming faster.

3. For those special fabrics such as mesh fabric, mercerized cotton etc, the stitches are easily accomplished as well as the trimming by the professional computer controlled without mistake-trimming.

4. Functions with auto stop sewing after trimming and with no fabric can save the stitches.

5. VTA trimmer is controlled by air cylinder, which reduces the blade stroke times and extends the durability.

BKT**简易式自动包线头**
SIMPLY AUTO BACK LATCH

为ECA延伸功能，车缝效率极高，针板有特殊风道设计，线头在切线後，瞬间吸回，线头长度约3cm

It is an ECA extending function. The sewing efficiency is very high. Special needle plate suction channel is for thread-end down turning. It pulls back the chain while a wink. The back latch length is about 3cm.

UC**上下层防卷边**
TOP AND BOTTOM ANTI-CURLY MATERIAL

针对易卷曲布料所开发的气动装置，在布料进入压脚之前，将布料吹平，可适用上卷，下卷等各种卷曲的情形，大幅增加车缝效率

The pneumatic device solves the problem of curly edge material. The fabric edge is flattened by air before entering the presser foot. Applicable to up-roll, down-roll, and all kinds of curly edge situations, which highly improves the sewing efficiency.

SD**圆领衫颈後贴条**
T-Shirt Neck-back Tape Attaching

以气动方式控制喇叭的水平位置 (布条上料与切断)，标准喇叭之规格：入布宽度 36MM，出布宽度 18MM

Control the folder's horizontal positions (tape feeding and cutting). Standard folder's specification: Tape width 36mm, finish width 18mm.

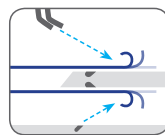

▲ 外卷模式
Up-roll

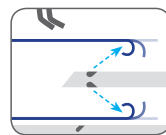

▲ 内卷模式
Down-roll

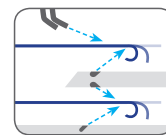

▲ 内外卷模式
Up-roll and Down-roll

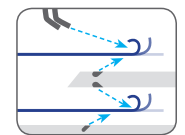

由于对产品的改良及更新，本产品型录中之产品规格及外观的修改恕不事先通知！

The specification and/or appearances of the equipment described in this catalogue are subject to change without previous notice because of modification.

C.S2019-03 MAY 2019